



oakheart

£300,000

Offers In Excess Of
Van Diemens Lane, Chelmsford

Nestled in the charming Van Diemens Lane, this beautifully presented two-bedroom mid-terrace house offers a delightful blend of comfort and convenience. As you step inside, you are welcomed by a spacious lounge/diner, perfect for both relaxation and entertaining guests. The well-appointed kitchen features integrated appliances, making meal preparation a breeze.

The property boasts two inviting bedrooms, providing ample space for rest and personalisation. The modern bathroom is

equipped with a bath with a shower over ensuring a stylish and functional space for your daily routines.

Some of the standout features of this home is its stunning rear garden which is perfect for entertaining and its prime location. It is conveniently situated for easy access to Chelmsford's vibrant city centre, train station, and the A12, making it an ideal choice for commuters and those who enjoy the amenities of urban living.

This terraced house is not just a place to live; it is a home that offers a wonderful lifestyle in a sought-after area. Whether you are a first-time buyer or looking to downsize, this property is sure to impress. Do not miss the opportunity to make this lovely house your new home.





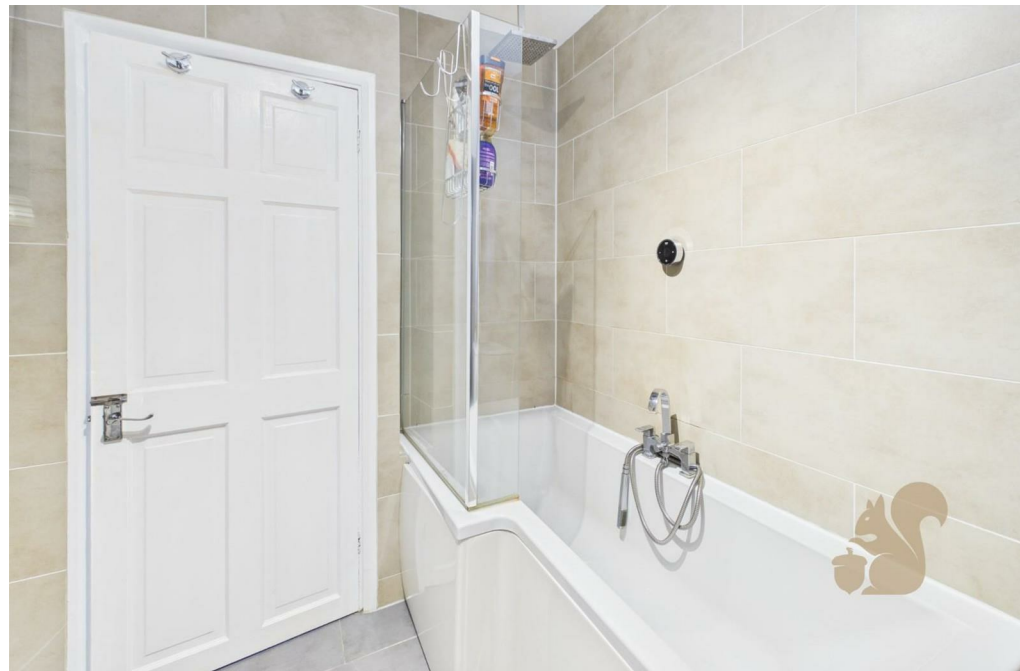



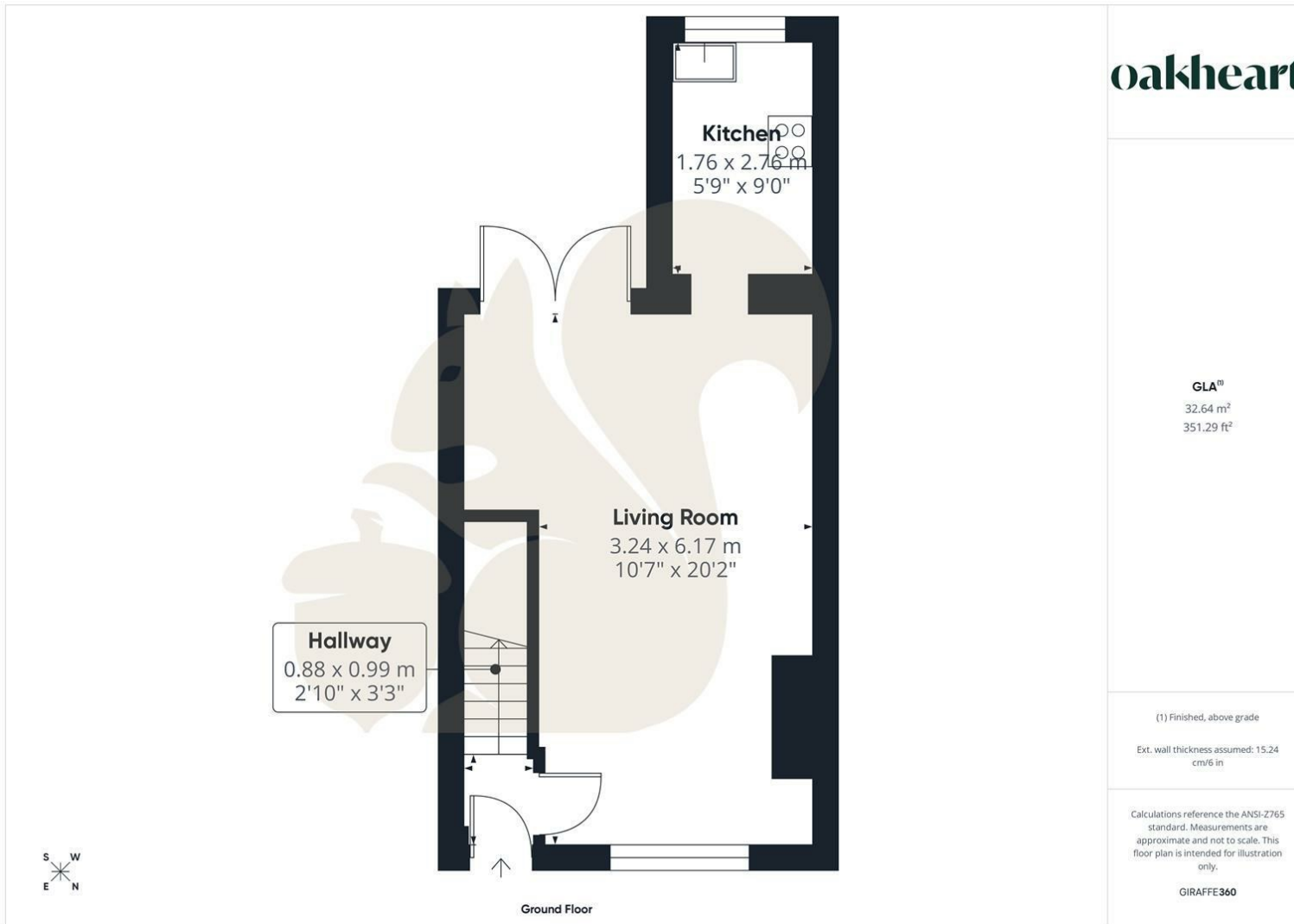

Local Authority:

Tenure:
Freehold

Council Tax Band:
C

Energy Efficiency Rating		Current	Potential
<i>Very energy efficient - lower running costs</i>			
(92 plus) A			
(81-91) B			
(69-80) C			
(55-68) D			
(39-54) E			
(21-38) F			
(1-20) G			
<i>Not energy efficient - higher running costs</i>			
England & Wales	EU Directive 2002/91/EC		

Agents Note: Whilst every care has been taken to prepare these particulars, they are for guidance purposes only. All measurements are approximate and are for general guidance purposes only and whilst every care has been taken to ensure their accuracy, they should not be relied upon.

Oakheart Chelmsford
01245 800181
chelmsford@oakheart.co.uk
20 Victoria Road, Chelmsford, Essex, CM1 1PA

oakheart